

MPDSA-12K Desktop Mount

Dual Link Single Display Kit

Best In Class Desktop Mounting Solution

- Plate design is VESA Compatible for displays up to 100 x 100mm
- Full motion tilt up to 30° forward and 90° backward provides ability to find the best view
- Easy fingertip adjustment: fine tuning the display tilt and leveling requires minimal effort
- Up to 90° of side to side roll for perfect display adjustment
- Lockable tilt positioning
- 180° swivel at two arm link points and 360° swivel at center arm link point allows for a wide variety of viewing angles



SKU	Display Size	Max VESA	Tilt	Max Load
MPDSA-12K	10-32"	100x100mm	+30°/-90°	30 lb

Kit Includes Multiple Desktop Hardware.

Choose your desktop application

This kit allows for an out of the box experience to accommodate most desktop installations.

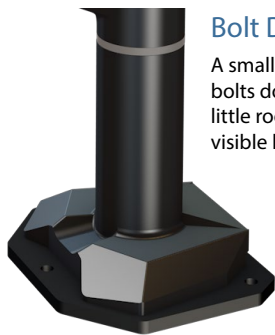

Bolt Down:

A small footprint that bolts down and takes up little room with minimal visible hardware.



Edge Clip and Wall:

Securely clamps to the edge of a desk and or directly to the desired wall.

THREE SWIVEL POINTS

180° and 360° Swiveling Capability

Three connection points allow for 180° at two outer links and 360° center link swivel to achieve a wide range of viewing angles.

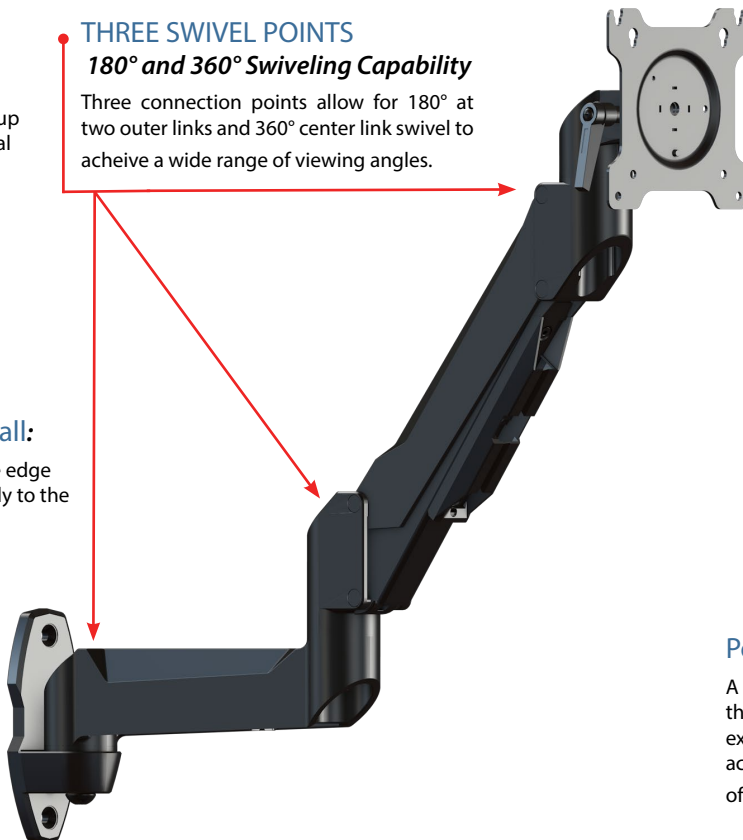

Hole:

Attaches to the desk through small hole and is secured from under the desktop surface.



Pole:

A low-profile adapter that easily clamps to existing pipes up to 2" to accomplish a wide variety of creative installations

MPDSA-12K Articulating Desktop Mount

Dual Link Single Display Kit



Attribute	Value
Display size	10" - 32"
Orientation	Landscape or portrait
Weight capacity	30lbs (14kg)
Max mounting pattern	100x100mm
Construction	High-grade cold rolled steel/aluminum
Tilt	-90°/+30°
Lock tilting	Yes
Color	Black
Model number	MPDSA-12K
Warranty	Limited lifetime

Ideal for displays and monitors between 10" - 32", the MPDSA articulating single link monitor arm mounts directly to walls and configures to portrait or landscape orientations. These elegant yet heavy-duty spring-loaded, full motion mounts accommodate monitors and associated accessories weighing up to 30 lb.

